

+Brisbane Metro Bus Portal - Cultural Centre, South Brisbane

This proposal seeks to establish the Cultural Centre as a destination, rather than purely a thoroughfare.

By creating a walkable piece of urban fabric new opportunities and connections are discovered. On approaching the building from the newly-pedestrianised corner (Melbourne St. and Grey St.) you are struck by raw concrete forms and softer sloping gardens, which form both the openings into the station and an amphitheatre that leads above.

From Grey Street, a laneway forms allowing local artists to display their works. A grassed amphitheatre gradually slopes up to meet on the Green Deck a new initiative that connects the metro building to South Brisbane Train Station and Fish Lane via a deck running parallel to train tracks and hosting a variety of green public spaces. The Cultural Centre also will facilitate retail occupancies, ticketing and information, public amenities, and various places to relax and meet.

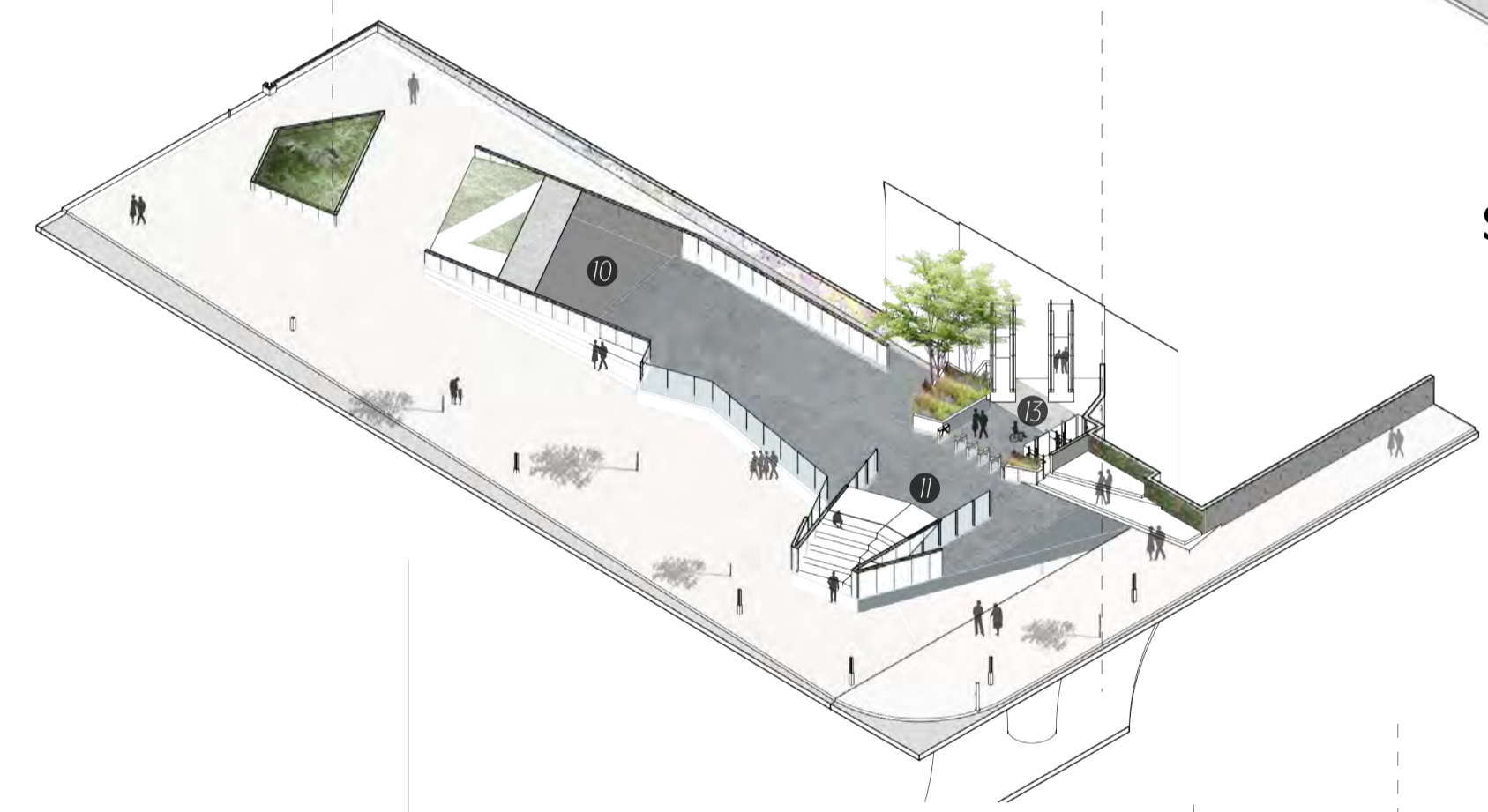

- 1 STAGE / SEATING
- 2 LOCAL ARTIST LANEWAY
- 3 AMPHITHEATRE
- 4 GREY ST ENTRY
- 5 MAIN STAIRS
- 6 LIFT ACCESS
- 7 MELBOURNE ST ENTRY
- 8 HIGHLINE
- 9 FISH LANE ACCESS
- 10 RETAIL SPACE (CAFÉ) / PUBLIC AMENITIES
- 11 TICKETING & INFO
- 12 MEETING SPACE W/ GREEN WALL VOID
- 13 TICKETING GATES / GARDENS
- 15 LIFT AND ESCALATOR ACCESS
- 16 METRO PLATFORM

INSPIRATION

1. UDAO ANDO - CONCRETE / 2. BIG - CC IN DENMARK / 3. RIKEN YAMAMOTO - HILL / 4. SOU FUJIMOTO - LEARNING CENTRE / 5. JAMES CORNER FIELD - NYC HIGHLINE

